

PUZ construire ansamblu de cladiri cu functiunea de locuinte colective si functiuni conexe, Rh P+3E+4R si accent P+8E

Str. Republicii, NC 36484 si NC 36483

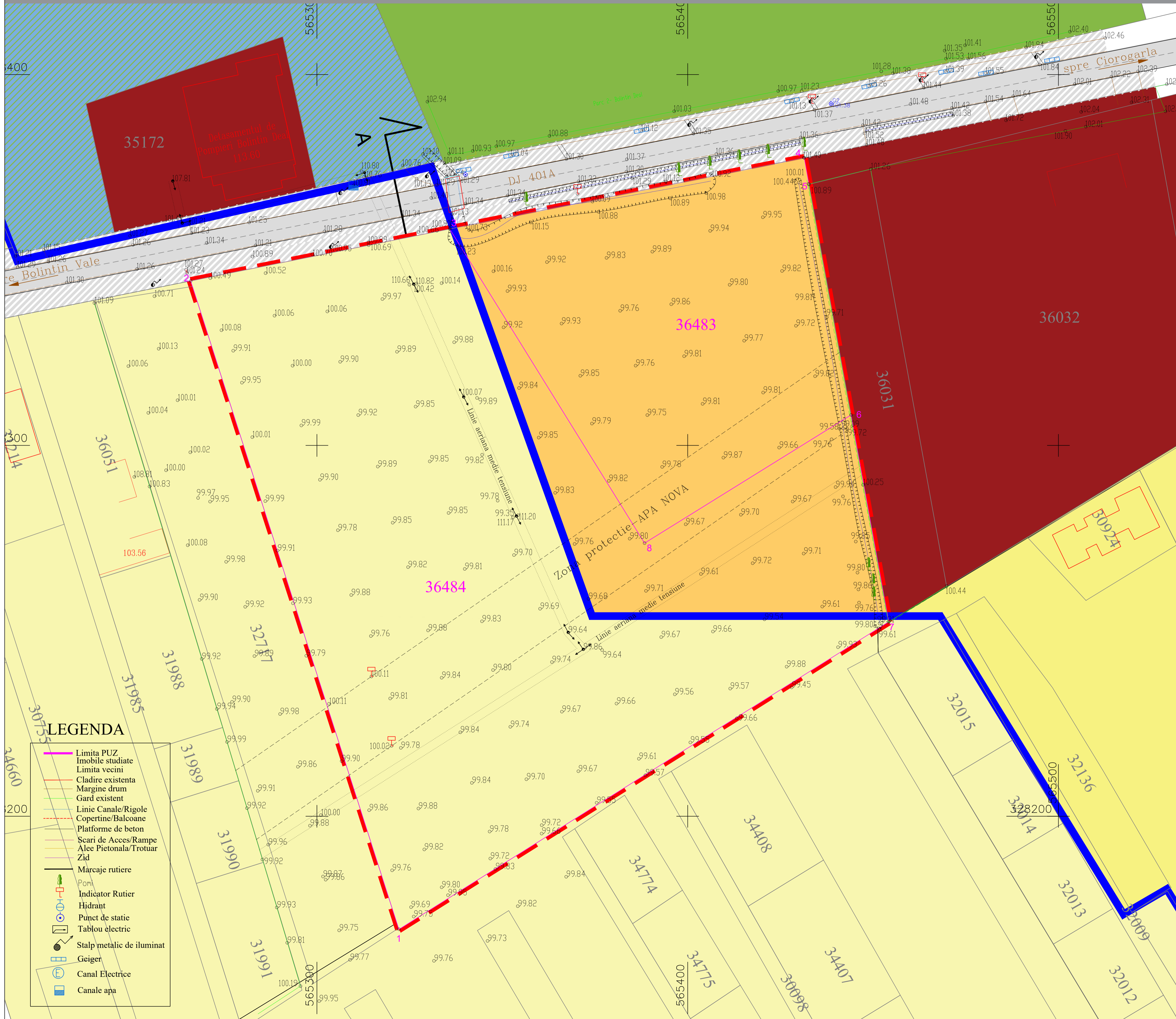
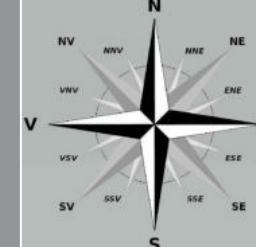

Limita-PUZ

Nr. Pct.	Coordonate pct.de contur	Lungimi laturi D(i,i+1)
	X [m] Y [m]	
1	328169.519 565322.116	183.639
2	328344.357 565265.946	71.258
3	328358.365 565335.814	97.524
4	328377.537 565431.435	7.270
5	328370.385 565432.738	63.185
6	328308.223 565444.066	56.696
7	328252.446 565454.231	155.985

S(Limita-PUZ)=24607mp

IE36483

Nr. Pct.	Coordonate pct.de contur	Lungimi laturi D(i,i+1)
	X [m] Y [m]	
5	328370.385 565432.738	63.185
6	328308.223 565444.066	56.545
8	328273.659 565388.376	99.689
3	328358.365 565335.814	97.524
4	328377.537 565431.435	7.270

S(IE36483)=6702mp

IE36484

Nr. Pct.	Coordonate pct.de contur	Lungimi laturi D(i,i+1)
	X [m] Y [m]	
6	328308.223 565444.066	56.696
7	328252.446 565454.231	155.985
1	328169.519 565322.116	183.639
2	328344.357 565265.946	71.258
3	328358.365 565335.814	99.689
8	328273.659 565388.376	65.545

S(IE36484)=17905mp

Legenda

- Limite**
- Limita teren reglementat
 - Limite cadastrale
 - Limita PUZ Zona Centrala
 - Limita constructii existente
- Zone functionale existente**
- UTR L2 cf. PUG - subzona locuinte individuale si colective mici cu maxim P+3E niveluri situate in noile extinderi sau enclave neconstruite
 - UTR Zc_L1 cf. PUZ ZC - Zona mixta locuinte colective mici P+3+M si comerț/servicii
 - UTR Zc_ICS cf. PUZ ZC - Zona institutiilor publice, servicii, comerț
 - UTR Zc_LMP cf. PUZ ZC - Zona mixta - Locuinte si comerț/servicii
 - UTR Zc_ZVS cf. PUZ ZC - Zona spatiilor de agrement si sportive
 - UTR Zc_ZVP cf. PUZ ZC - Zona spatiilor verzi publice
- Circulatii**
- Circulatii rutiere existente
 - Zona adiacenta circulatiilor rutiere (rigole, drum de pamant)

LEGENDA

- Limita PUZ
- Imobile studiate
- Limita vecini
- Cladire existenta
- Margine drum
- Gard existent
- Linie Canale/Rigole
- Copertine/Balcoane
- Platforme de beton
- Seari de Acces/Rampe
- Alee Pionala/Trotuar
- Zid
- Marcaje rutiere
- Pom
- Indicator Rutier
- Hidrant
- Punct de statie
- Tablou electric
- Stalp metalic de iluminat
- Geiger
- Canal Electric
- Canale apa

Profil existent A-A - str. Republicii (DJ 601/DJ 401A)

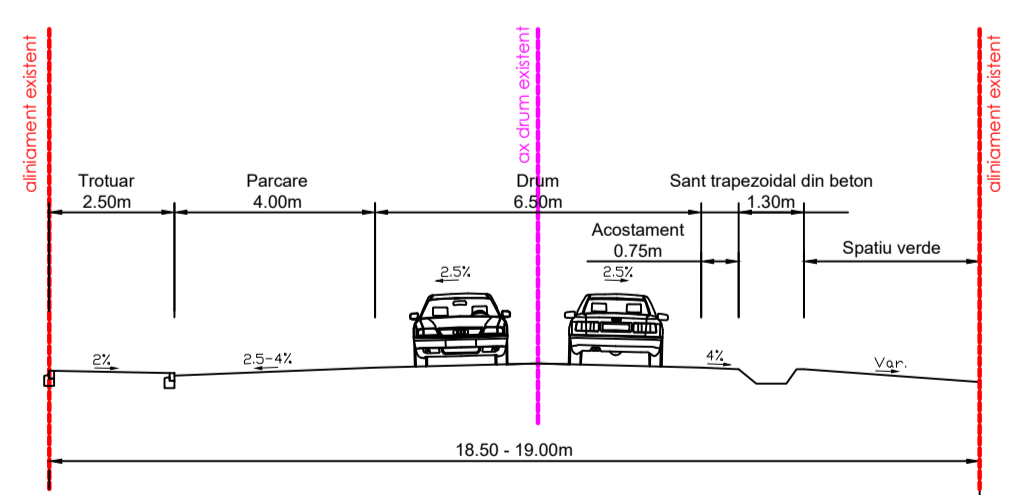

VERIFICATOR	NUME	SEMNTURA	CERINTA CALITATE	REFERAT / EXPERTIZA NR/ DATA
PROIECTANT GENERAL:	AVENTUS DESIGN	AVENTUS DESIGN S.R.L. Sala Independentei 291-293, et.11, sector 6, Bucuresti office@aventus.ro www.aventus.ro	BENEFICIAR: CTPARK MANAGEMENT AFUMATI S.R.L. CUI: 43411930 / J239510/2020 Sedi: Sat dragomiresi Deal, comuna Dragomiresi vale, Strada Gabriela, Nr.1, Căderea B, jud. Ilfov	NUMAR PROIECT
SEF PROIECT	urb. Diaconu Alma		SCARA	1:500
PROIECTAT	urb. Diaconu Alma		DATA	SEPT 2023
DESEMAT	urb. Diaconu Alma		NUME PLANSA	PLAN SITUATIE EXISTENTA
				NUMAR PLANSA
				U.02